



355 x 140 x 57 mm



2.1 kg



Steel / HDG



BS EN 13374, class A

Description

The VT Edge round is designed for connection to vertical surfaces such as a slab edge, stair stringer, wall or facade.

The post is off-set from the structure by 80mm to allow for finishing works. However when used with a Vivatec barrier the return at the bottom of the barrier completely closes up the gap between post and structure.

A distinct tether point marked with orange labeling indicates where a user should connect a caribiner or similar.

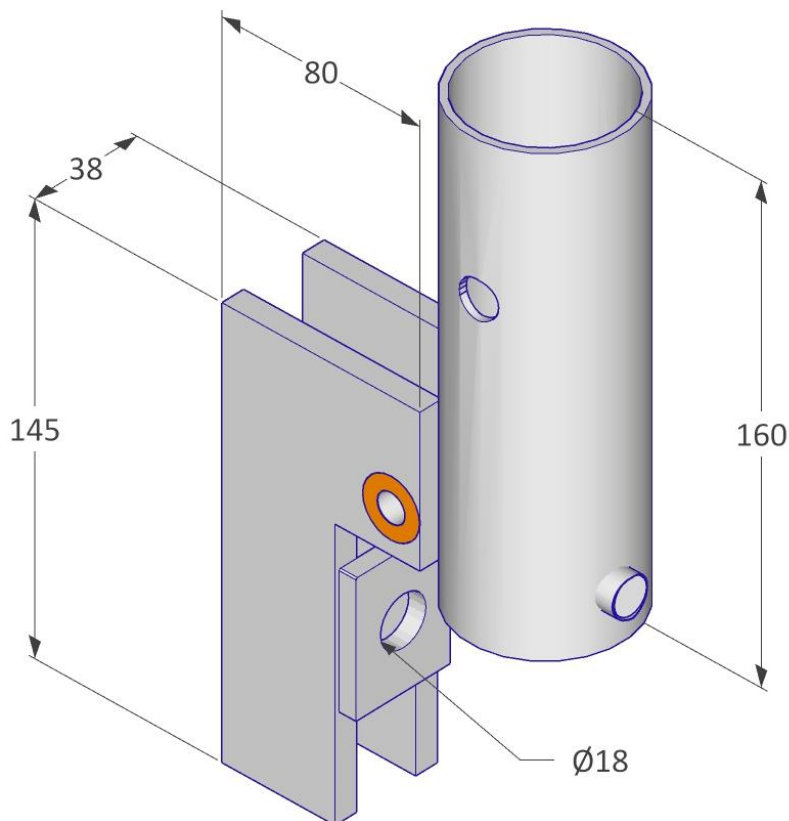

250 pcs / Eurobox



1240 x 835 x 970 mm



595 kg

Means of Fixation

Tensile load of the screws min. 10 kN
→ Hilti HUS3-H10 L-130mm or the like / better, assembly torque limit min. 60 Nm

General Safety

Health and Safety Regulations should be followed at all times. For more information → viva-tec.co.uk/safety

mm



355 x 140 x 57 mm



2.1 kg



Steel / HDG



BS EN 13374, class A

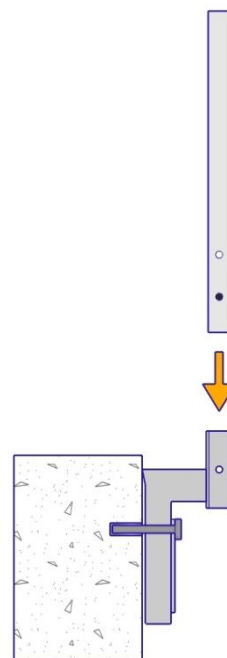
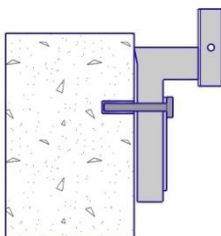
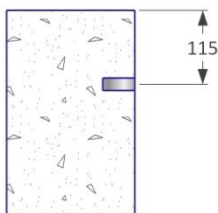
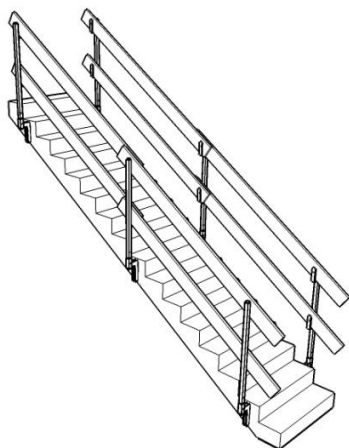
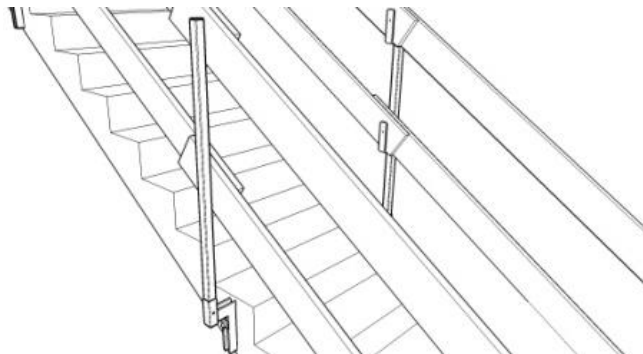

mm



250 pcs / Eurobox



1240 x 835 x 970 mm



595 kg

Means of Fixation

Tensile load of the screws min. 10 kN
→ Hilti HUS3-H10 L-130mm or the like / better, assembly torque limit min. 60 Nm

General Safety

Health and Safety Regulation should be followed at all times. For more information → viva-tec.co.uk/safety